

Scale 1:2500@A1

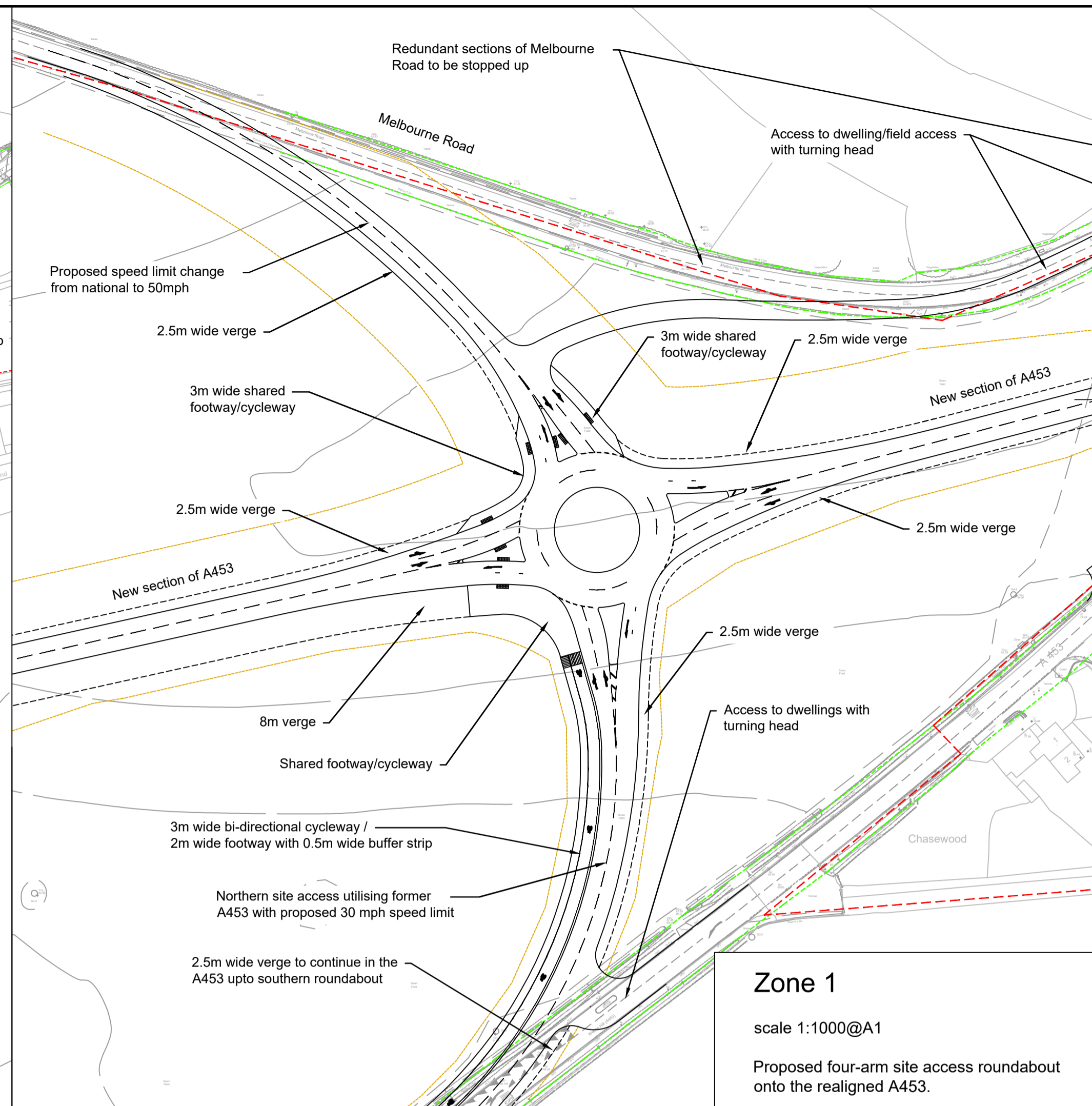

Zone 1
 scale 1:1000@A1
 Proposed four-arm site access roundabout onto the realigned A453.

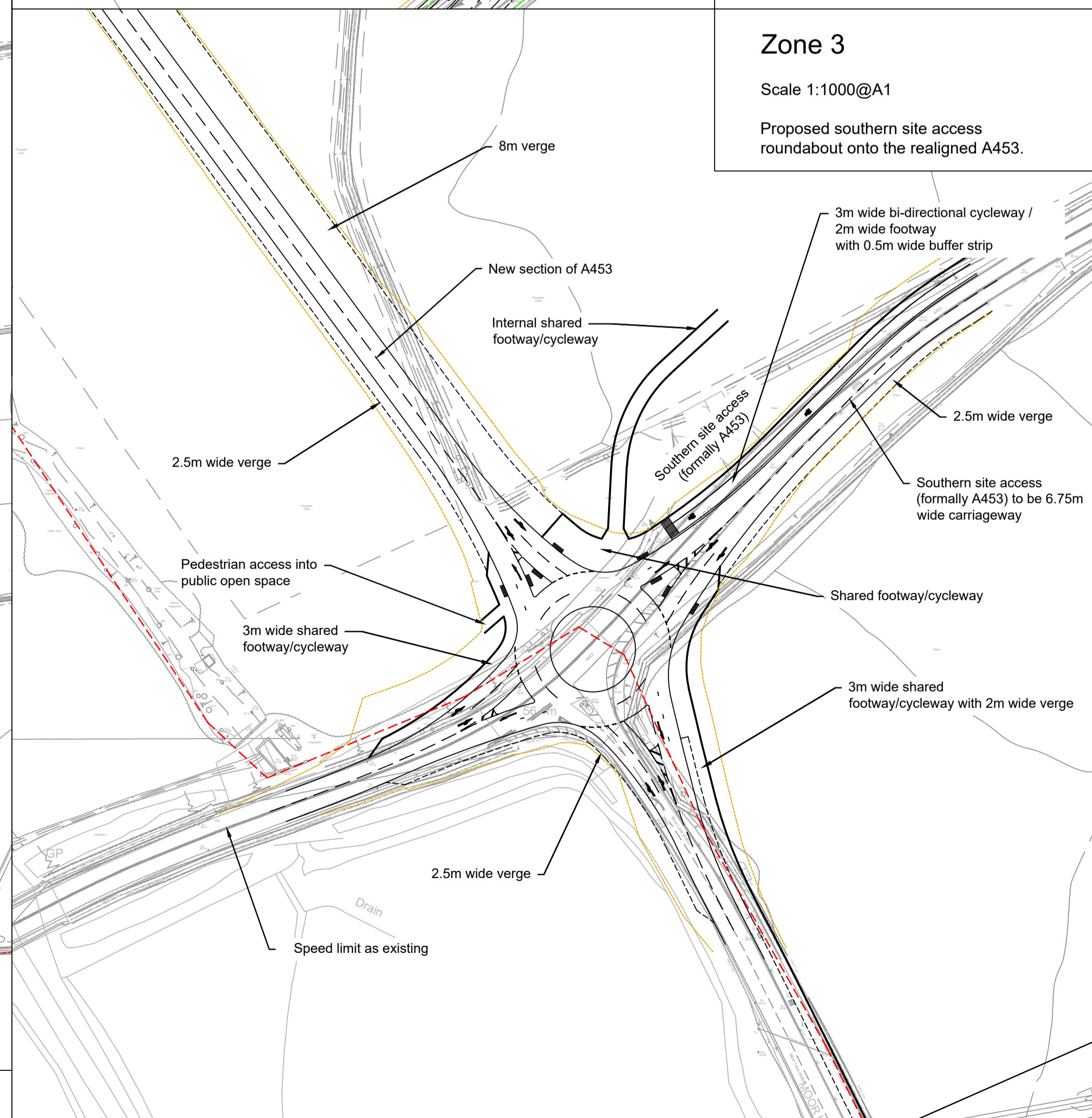

Zone 3
 Scale 1:1000@A1
 Proposed southern site access roundabout onto the realigned A453.

- Notes**
1. Do not scale this drawing. All dimensions must be checked/ verified on site. If in doubt ask.
 2. This drawing is to be read in conjunction with all relevant architects, engineers and specialists drawings and specifications.
 3. All dimensions in metres unless noted otherwise. All levels in metres unless noted otherwise.
 4. Any discrepancies noted on site are to be reported to the engineer immediately.

- - - Site Boundary
- - - Existing Highway Boundary
- - - Proposed Earthwork Extents (Final extents are subject to modelling refinements and site conditions)

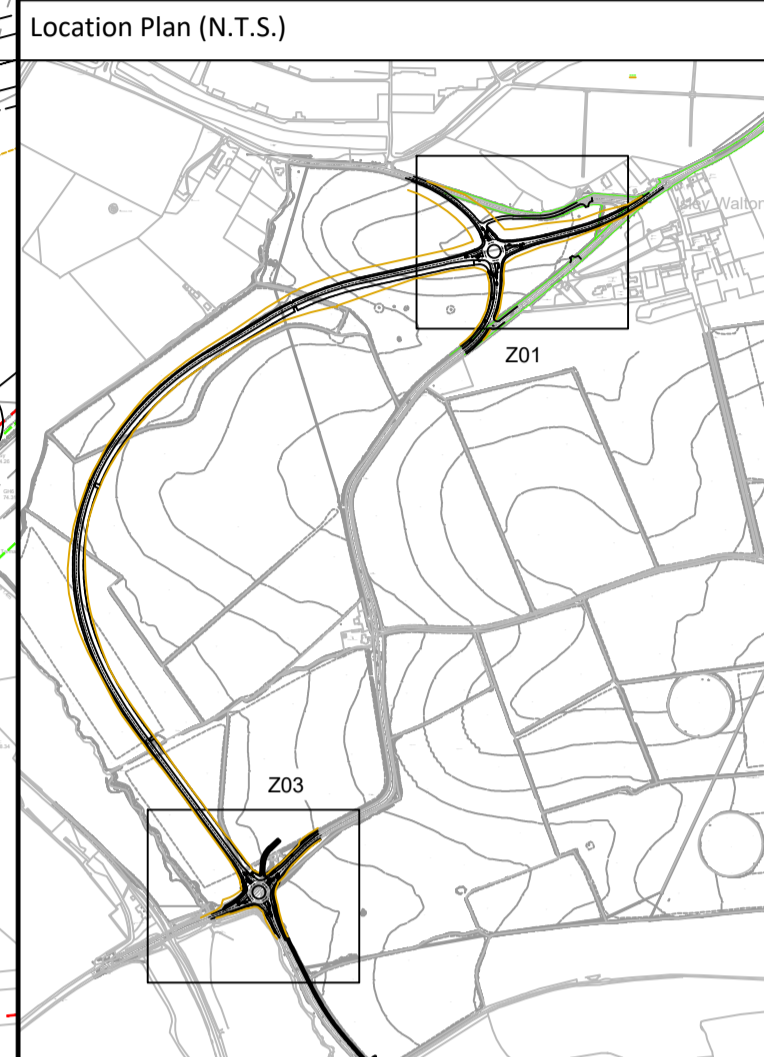

Rev	Date	Description	Dr	Rev
P5	20.03.25	Alignment and NMU revision	AH	DAC
P4	14.04.23	Pegasus comments	AB	DAC
P3	21.03.23	Junction 5 layout deleted	AB	DAC
P2	26.05.22	Junction 3 layout amended	MH	DAC
P1	06.05.22	first version	MH	DAC

Client:
Caesarea/Harworth Group

Project:
Isley Woodhouse

Title:
 Proposed A453 realignment and site access roundabouts
 General Arrangement



Drawn: M. Higgins
 Reviewed: D. Cummins
 Size: A1
 Scale: As shown
 Date: 06 / 05 / 2022

Status:
PRELIMINARY ISSUE

Project Reference	Type	Number	Revision
ADC2570-DR-	002		P5